





# BasketBlacks

**Basket Filters**  
**Model: BasketBlack FBB-S**

# Basket filters BagBlackS

A basket filter is a type of filter designed for the removal of all suspended solids present in surface waters (rivers, lakes, sea) of wells and springs. Basket filters are used for the removal from water of: leaves, branches, pebbles, sand, rust, pests, insects and other large particles.

Basket filters guarantee:

-  high performance
-  easy and quick maintenance
-  cost saving



**BagBlackS** basket filters are technically and economically the best solution currently available on the market as pretreatment for self-cleaning filters, for the protection of pumps and to give continuity to the filtration process after sand filters or resin plants for the construction of high flow filtration plants.

Their undisputed uniqueness, thanks to the use of certified raw materials of high quality, always guarantees better performance than any possible alternative.



*the most  
technologically  
advanced solution  
for filtration  
with filter baskets*

# Basket filters BagBlackS

BasketBlackS basket filters are produced in different sizes:

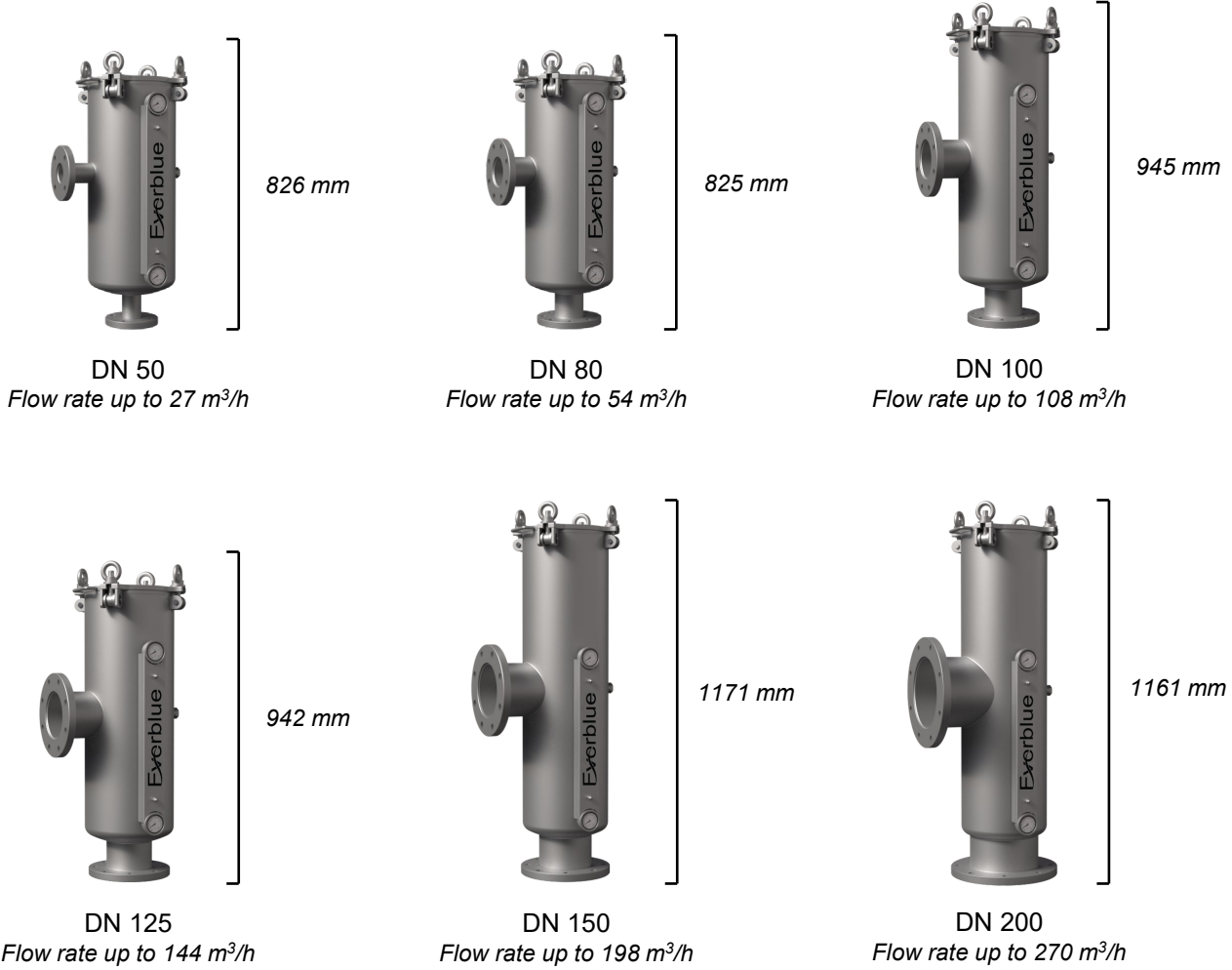

BasketBlackS basket filters guarantee:

  
**Versatile**  
*It is suitable for a wide range of flow rates and can be installed either vertically or horizontally*

  
**Complete resistance to corrosion**  
*Guaranteed long service life, thanks in part to the micro-shot peening treatment*

  
**Cost-effective**  
*Reduced installation (Capex), operating (OpEx) and maintenance costs*

*\*Also available in a DUPLEX version on request*

# Why choose BasketBlackS: structure

BasketBlackS basket filters consist of 3 basic parts:

## 1 FILTER BASKET

The filter basket is the “operational” part of the filter, it is made entirely of plastic material (PVC) inside which there are two polypropylene drainage nets and a polyester filter net; this allows you to make the most of the entire filter surface of the basket.

The filter basket retains particles in the water ranging in size from 50 µm to 3000 µm with a high efficiency rate of 85%.

## 2 FILTER BODY

Made from AISI 316L stainless steel and treated using passivation, pickling and micro-shot blasting processes, it is suitable for use with brackish water having a salinity of less than 5000 ppm TDS (Total Dissolved Solids).

The filter body is designed to allow for both vertical and horizontal installation, without the need for special brackets, but enabling secure fixing via the connections (IN and OUT). Furthermore, its robustness and sturdiness allow it to operate at a maximum pressure of 8 bar.

## 3 FILTER CAPS

Made of the same AISI 316L steel as the filter body, treated by passivation, pickling and micro-lining processes, it can work with brackish water with a salinity below 5000 ppm TDS (Total Dissolved Solids).

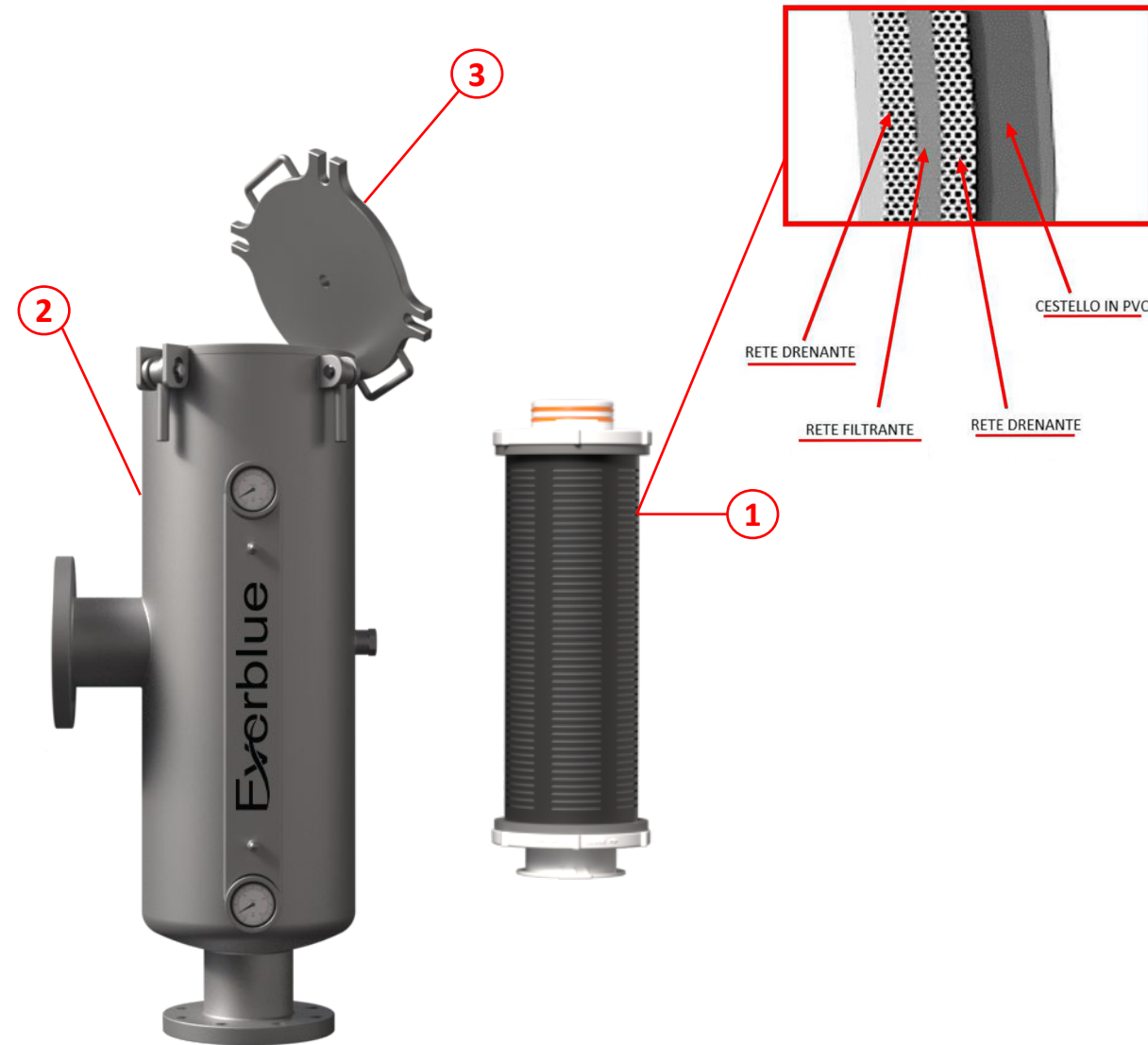

## Why choose **BasketBlackS**: easy of maintenance

Installing the **BasketBlackS** basket filters is very simple and takes just a couple of minutes.

- 1 Unscrew and remove the nuts and washers that secure the cover to the **BasketBlackS** filter body:



- 2 You can therefore remove the entire **BasketBlackS** filter cover using the handles provided:



- 3 Carefully grasp and remove the basket from the **BasketBlackS** filter housing:

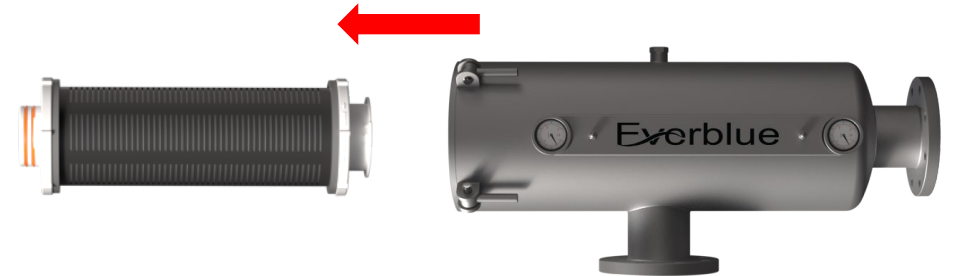

- 4 Reinsert the basket, followed by the lid, fit the washers and tighten the bolts to reassemble the **BasketBlackS** filter:



# Why choose BasketBlackS

## Uniqueness

**BasketBlackS** basket filters are absolutely **unique** products because:

- They are the synthesis of the best technologies currently available on the market
- They are available in various sizes and can be installed either vertically or horizontally
- They are designed to accommodate a multi-layer filter basket that allows optimal filtration

## Simplicity

**BasketBlackS** basket filters are absolutely easy to use:

- One operator opens and closes the **BasketBlackS** container manually and in a few minutes.
- BasketBlackS** filter baskets can be quickly inserted and removed thanks to the top handle



## More Info



*DataSheet*  
**BasketBlackS**



*Video*  
**BasketBlackS**



*Technical Courses*

# Contact Us



Everblue

Via Alberto Zanrè, 16 - Loc. Gotra 43051 Albareto (PR)

[www.everblue.it](http://www.everblue.it)

+39 0525-1920100

[info@everblue.it](mailto:info@everblue.it)

